

These rugged, motor-actuated PVC ball valves are designed and assembled in the USA for demanding agricultural applications requiring irrigation control and facility water management. The BV100, BV125 and BV150 valves combine high-quality components for reliability that your crop can depend on.

The full-port PVC ball valve is a tru-union type with interchangeable flanges for either NPT threaded pipe, or solvent weld sockets.

High-torque Italian-made actuator from one of the largest actuator manufacturers in the world features an over-sized motor and heavy steel gearing for a long service life. Manual override knob allows operation even in the event of a power failure.

BV series valves are powered by 24VDC and do not have a minimum operation time. See manual for wiring instructions and requirements.

Valve Approvals: ANSI B1.20.1 ASTM F1970  
 Pressure Rating: 150PSI @ 73°F



Shown with threaded fittings; includes socket weld fittings.



BV100 1"

BV125 1-1/4"

BV150 1-1/2"

## Features



True Union Schedule 80 Ball Valve  
 Thread & Socket Weld Flanges



Manual Operation Knob  
 Position Indicator



4 Second Rotation Time  
 No Minimum On-Time



Position Sensing Switches  
 Monitor Valve Open or Closed



Stainless Steel Bracket  
 Made in USA



Tough Industrial Grade Actuator  
 IP54, Made in Italy



Designed & Assembled in USA



1-Year Warranty

## BV100 1" Ball Valve

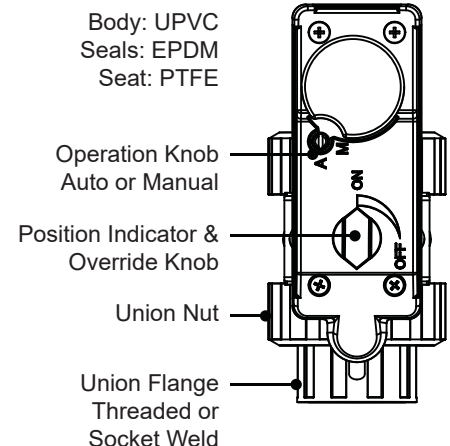
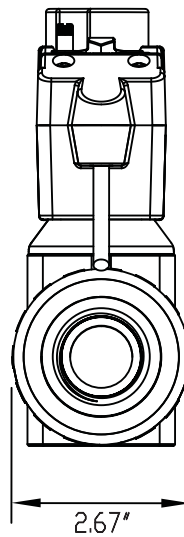
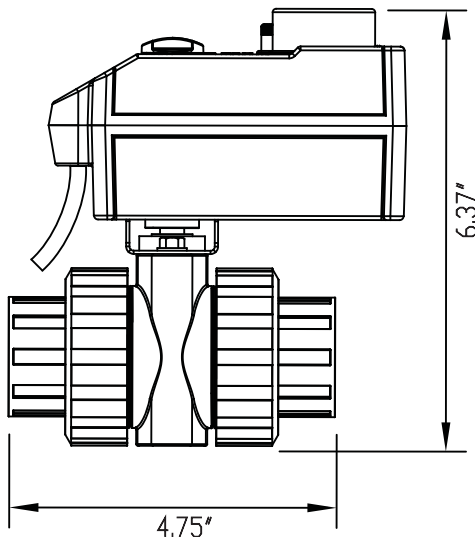

Wetted surfaces less than 0.25% lead content.

# BV Series

## Motorized Electric Ball Valve

BV125 1-1/4" Ball Valve

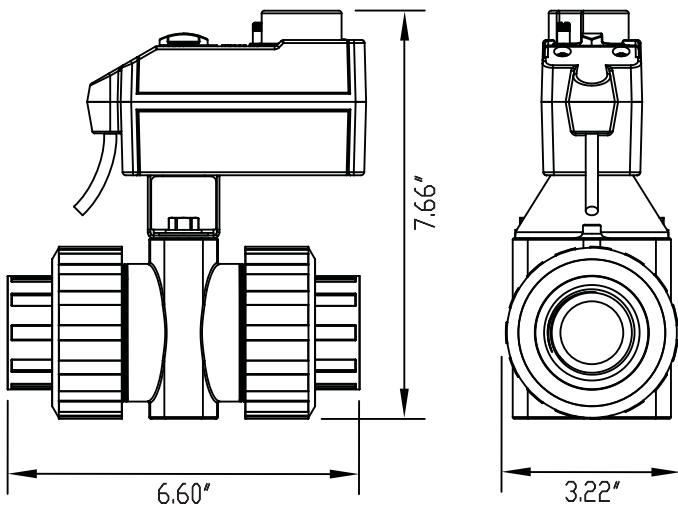

BV150 1-1/2" Ball Valve

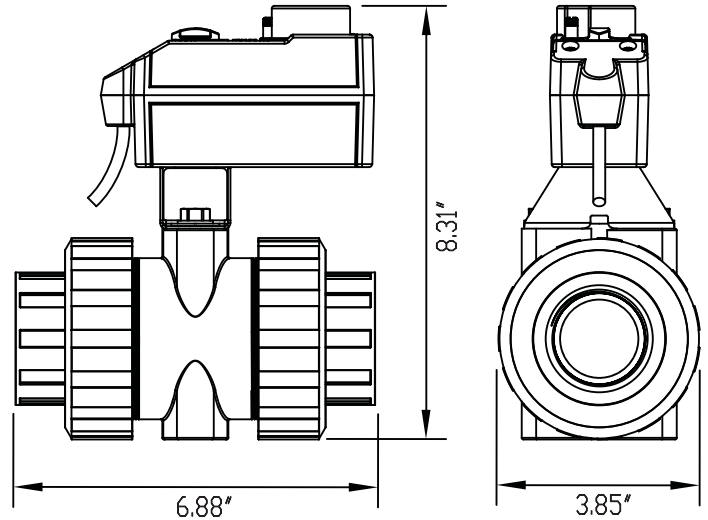

Manual Operation

Schematic

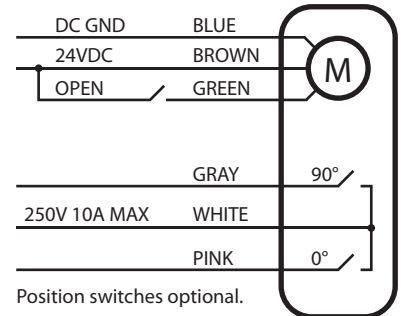
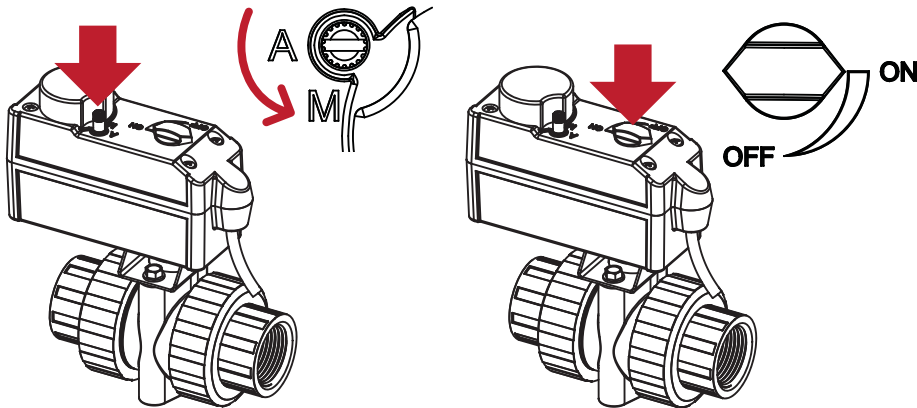

1. Press the operation selector down then rotate to the M position.
2. Rotate the position knob with a 10mm open end wrench.
3. Return the operation selector to the A position for electric operation.

Ordering Options

Optional Accessories

BV100S

- S: Standard (Normally Closed)
- R: Reversed (Normally Open)
- 100: 1 Inch Port & Flanges
- 125: 1.25 Inch Port & Flanges
- 150: 1.5 Inch Port & Flanges



VX8i valve controllers connect Agrowtek's ball valves to GrowControl™ GCX series control systems for automated irrigation management.